

BT Series

Dome-Top® Barb Ty Nylon Cable Ties

Features and Benefits

Non-serated cable tie with stainless steel barb for high performance applications where a semi-smooth cable tie binding surface is desired. Two piece design incorporates a stainless steel locking barb (AISI 316 grade) in a nylon cable tie. Offering a high loop tensile strength that exceeds industry standards.

Features & Benefits

- Dome-Top head features unique patented design with round, smooth edges.
- Stainless steel locking barb, provides consistent performance, reliability and infinite adjustability through entire bundle range.
- High strength and low initial insertion force.
- A variety of materials and colours are available for specific applications.
- UL Listed for use in plenum or air handling spaces per NEC.



This product section covers the more popular standard locking tie, for variants such as Clamp, Flag, Marker Push Mount and Locking Tie please contact us for additional information.

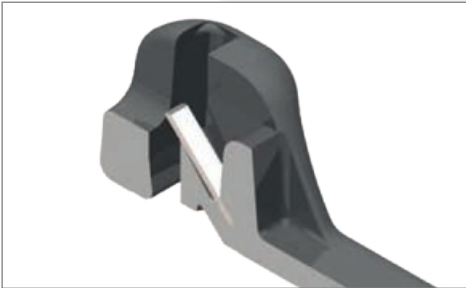

Dome-Top head features unique patented design with round smooth edges. Plus stainless steel locking barb provides infinite adjustability through bundle range.

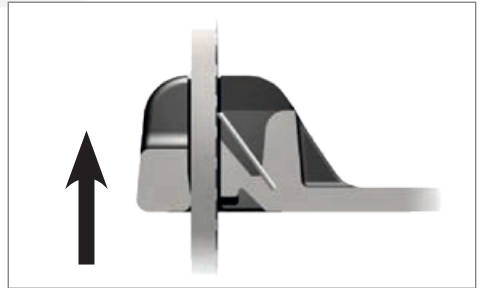

Patented low thread force design reduces operator fatigue and improves productivity.



Curved tip threads easily and installs faster. Finger grip ensures positive grip during threading of tie.



Ribbed and stippled strap body prevents lateral movement on the bundle.

Part Number System

Various packaging and material options are also available as outlined below;

BT	BT	Type
BT9	9	Size. Approx bundle Dia. (inch)
	LH	Light Heavy
	M	Miniature
	I	Intermediate
	S	Standard
BT9LH-	C	Standard packaging 100 pcs.
	L	Standard packaging of 50 pcs.
	M	Bulk packaging of 1,000 pcs.
BT9LH-C	0	Weather resistant Black tie

Variants Available

- Clamp Ties
- Wing Push Mount Ties
- Push Mount Ties
- Marker and Flag Ties

BT9LH-C0

Nylon 6.6 cable tie, for max bundle dia. of 152mm, colour black, packed in 100pcs.

Order Description	Length	Width	Thick	Head Height	Head Width	Max Bundle Dia.	Min. Tensile Strength	Recommended Installation Tool
Miniature Cross Section Ties								
BT1M-C	102	2.4	0.9	4.0	4.4	23	80N	GTS, GTSL, GS2B, PTS, PPTS, STS2
BT1.5M-C	160	2.4	1.2	4.0	4.6	38		
BT2M-C	201	2.4	1.2	4.0	4.6	51		
BT4M-C	361	2.4	1.2	4.0	4.6	105		
Intermediate Cross Section Ties								
BT1.5I-C	155	3.6	1.0	4.7	6.3	38	178N	GTS, GTSL, GS2B, PTS, PPTS, STS2
BT2I-C	203	3.6	1.0	4.7	6.3	51		
BT3I-C	287	3.6	1.2	4.7	6.3	76		
BT4I-C	363	3.6	1.2	4.7	6.3	102		
Standard Cross Section Ties								
BT2S-C	203	4.7	1.1	5.6	8.1	51	222N	GTS, GTSL, GS2B, GTH, GS4H, PTS, STS2, STH2
BT3S-C	305	4.7	1.3	5.6	8.1	76		
BR4S-C	384	4.7	1.3	5.6	8.1	102		
Light-Heavy Cross Section (straight tip) Ties								
BT2LH-L	221	7.0	1.7	8.1	13.2	51	534N	GTH, GS4H, GS4EH, PTH, STH2, ST3EH
BT3LH-L	300	7.0	1.7	8.1	13.2	76		
BT4LH-L	378	7.0	1.7	8.1	13.2	102		
BT5LH-L	460	7.0	1.7	8.1	13.2	127		
BT7LH-L	620	7.0	1.7	8.1	13.2	178		
BT9LH-L	780	7.0	1.7	8.1	13.2	229		

Dimension in millimeters unless otherwise stated.