



Micro Moulded Boots

Lipped

Straight and Right Angle 90° boots

204W221-xx-G03

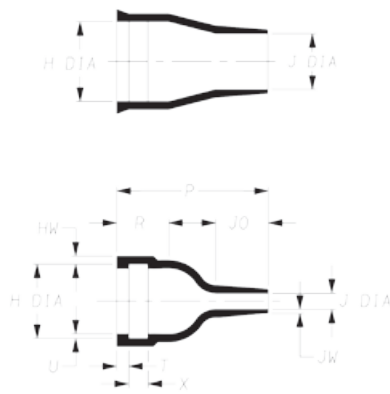

Before Recovery

After Recovery

224W221-xx-G03

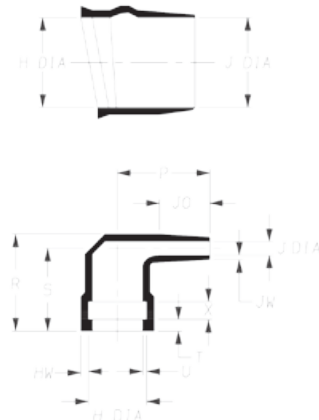

Before Recovery

After Recovery

Product Dimensions Selection Table

| Dimensions as Supplied | | | Dimensions After Recovery | | | | | | | | | | |
|------------------------|--------|----|---------------------------|-----|------|------|------|------|------|------|------|------|------|
| Dimension | H | J | H | J | P | R | S | T | U | X | JO | HW | JW |
| | | | | | ±10% | ±10% | ±10% | ±10% | ±10% | ±10% | ±10% | ±20% | ±20% |
| Material | 25,12* | | | | | | | | | | | | |
| Part Number | | | | | | | | | | | | | |
| 204W221-xx-G03 | 11 | 11 | 7.8 | 1.9 | 19 | 6.5 | | 1.5 | 0.55 | 2.4 | 6.6 | 1.1 | 0.5 |
| 224W221-xx-G03 | 11 | 11 | 7.8 | 1.9 | 12.3 | 13 | 11 | 1.5 | 0.55 | 2.4 | 6.6 | 1.0 | 0.6 |

Note * Please check dimensions for -12 material as may differ, as supplied dimensions may be slightly reduced due to the nature of the material. After recovery sizes are not affected. All dimensions in millimetres unless otherwise stated.

Ordering Information

- Standard colour Black.
- Size selection please refer to the table above.
- Specify the product name, material and coating required, as per example.

Part Number Example:

224W221-25-G03/225-0

Right angle 90° moulded part in fluid resistant elastomer, adhesive coating, colour black.

Materials Available

| Material | Material Description |
|----------|---------------------------|
| -12 | Fluoro-elastomer |
| -25 | Fluid resistant elastomer |

Environmental Adhesives Available

| Optional Pre-coat | Optional User Applied |
|-------------------|----------------------------|
| /225 | S-1255-04 |
| /225 | S-1017 or S-1048 or S-1125 |

For more information on materials and adhesives, please refer to relevant sections of this catalogue.